



# MANTEN MARINA



P O Box 30 Deneysville 1932  
1 Waverley Road Deneysville 1932

CK: 1995/04951523

TEL: (016) 371-1301

www.mantenmarina.co.za  
email: info@mantenmarina.co.za

## YACHT INVENTORY

<b>Design</b>	: Rayvin 30	<b>Name</b>	: Rayvin30_01
<b>Year</b>	: ? 2004 – 2009?	<b>Sail No.</b>	:
<b>Registration #</b>	:	<b>COF</b>	:
<b>Hull Type</b>	: Catamaran Twin Keel	<b>Rigging Type</b>	: Fractional Sloop
<b>LOA</b>	: 29.53 Ft / 9.00 M	<b>LWL</b>	: 28.41 Ft / 8.66 M
<b>Sail Area (Reported)</b>	: 609.24 Ft <sup>2</sup> / 56.60 M <sup>2</sup>	<b>Beam</b>	: 18.04 Ft / 5.50 M
<b>Displacement</b>	: +- 5,196.00 Lb / 2,357 Kg	<b>Max Draft</b>	: 2.95 Ft / 0.90 M
<b>Construction</b>	: FG Composite	<b>Builder</b>	: Rayvin Yachts (SA)
<b>Designer</b>	: Rajen Naidu	<b>Berthed</b>	: RCYC

### RIG:

Mast	1
Boom	1
Standing Rigging	Y
Running Rigging	Y
Spinnaker Pole	1



### SAILS:

Main with Stack Pack	1
Genoa	1
Gennaker	1

### DECK HARDWARE:

Primary S/T Winches	4
Winch Handles	2
ST/ST Pushpit	Y
Cleats & Fairleads	Y
BowSprit	1
Sun Canopy	1
Dive Platform	1

### INSTRUMENTS:

GPS	1
Compass	1
VHF Radio	1
Depth Speed and Log	1
Wind speed and direction	1



### ELECTRONICS:

Battery	5
Interior Lighting	Y

Navigation Lights	Y
Switchboard	1
Solar Panel	2

**MOTOR:**

18 HP Yanmar Inboard	2
Outboard Motor Bracket	1
Fuel Tank	1



**ACCOMMODATION:**

Berths	6
Cabins	3
Bunk Cushions	Y
Saloon Table	1



**HEADS & PLUMBING:**

Basin	1
Marine Toilet	1
Water Tanks	Y

Black Water Tank	
Bilge pump	

**GALLEY:**

Sink	1
Cool Box	1
Crockery and Cutlery	Y



**SAFETY EQUIPMENT:**

Anchor, Chain & Warp	1
Fenders	6
Life Ring	Y
Life Jackets	6
Fire Extinguisher	Y
Boat Hook	1
Fog Horn	1
First Aid Kit	1
Dan Buoy	1
Life Raft	

**EXTRAS:**

Stack Pack - new	1
Boarding Ladder	1

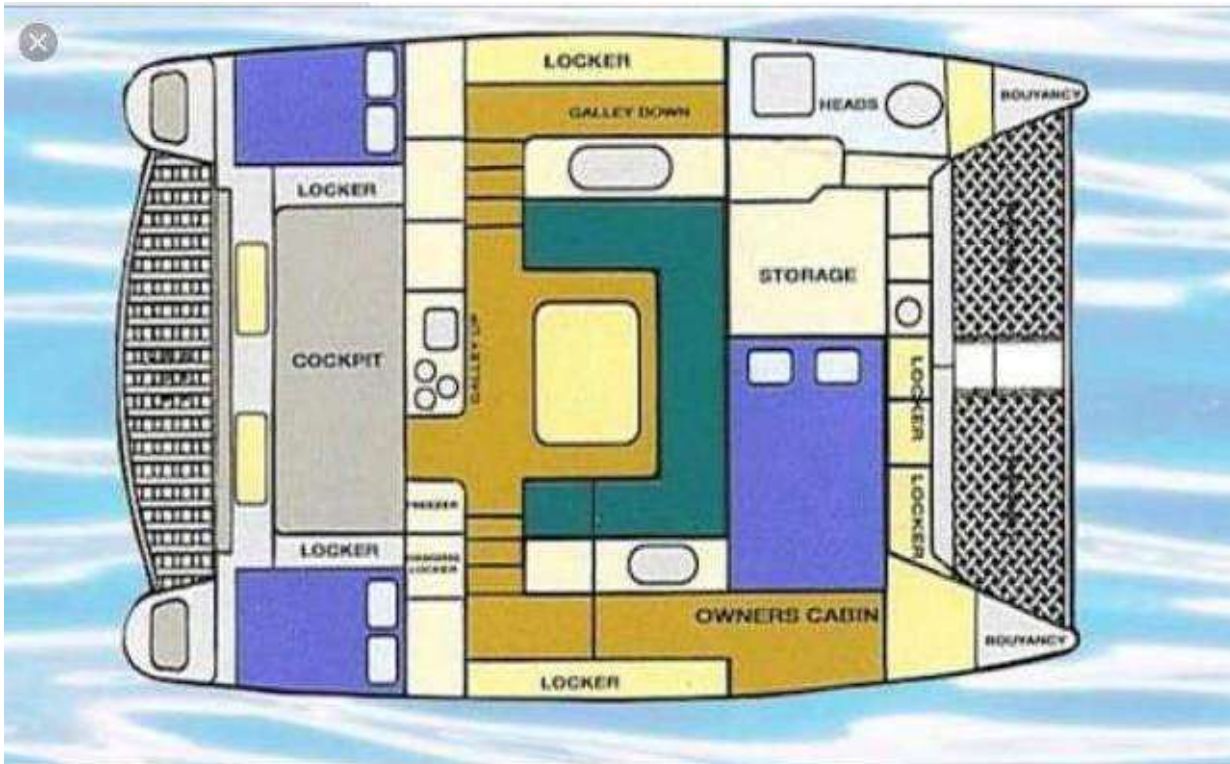

**PRICE: R 2 400 000**

N.B. The above information is to the best of our knowledge correct. Manten Marina cannot be held liable for the condition of equipment or for any items on the inventory being absent from the boat. The onus is on the purchaser to check the inventory of the craft and to satisfy himself that all the necessary sale requirements have been met.

Initials